

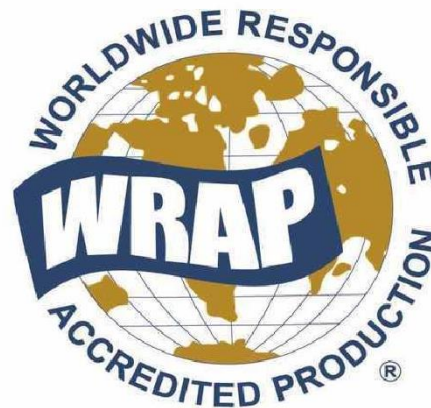

Factory Profile
OF
Murad Apparels Ltd.
South Gouripur, Ashulia,
Savar, Dhaka-1341, Bangladesh.

CERTIFICATIONS



Index



- **Contents**
- Introduction about Murad Apparels Ltd.
- Facilities
- Address
- Factory Details
- Production Capacity
- Product
- Fabrics
- Customer
- Sewing Floor Lay out
- Finishing Floor Lay out



- Ground Floor Lay out
- Store Department
- List of Machineries
- Special Machines
- Sample Section
- Cutting Section
- Sewing Section
- Quality Assurance
- Sewing Quality Control
- Finishing Department
- Process Follow For Finishing of Trouser
- Management



Introduction

Murad Apparels is a 100 % export oriented, comprehensive ready-made woven garment manufacturing unit with 16 lines factory on 57 acres land established on 2013. We deliver the best in buying and production services, ranging from sourcing; buying; production; quality control; following; creative services; image production and logistics. We offers a progressive way to manage your brand and increase your company's productivity, while reducing costs with security. We bring a relentless approach to style, quality, timing, communication, professionalism and efficiency. Exceptional quality is the foundation of our company and is the driving force behind all decisions; whether it's which materials to purchase or the best way to serve our customers. We specialize in Outwear and all kinds of Bottom including Suede and PU leather. Manufacturing facilities are Certified by **GOTS, BSCI, SeDex, WRAP, OeKo-TEX, OCS, ACCORD, ISO 9001:2015 (QMS) and C-TPAT**. The Lead time is 90 days to 120 days

Our commitment to quality guarantees, our success and your satisfaction.

Introduction



- Our last year turnover was \$30 million and we are expecting to achieve \$40 million in 2019.
- There are strong merchandising team and they can handle
- Developments, samples, sourcing and supply chain individually.
- We are sourcing fabric from china, India Pakistan and locally .
- We work on all kind of denim ,twill, canvas, corduroy ,linen, Polyester and poplin .
- We are strong in all Kind of Jacket,Bib,cargos, Fancy 5pkt ,chinos, active chinos, wash and non wash items
- Our monthly average productivity is **500,000** pcs.



- With latest & modern equipment.
- Open space for every worker as per the internationally accepted compliance law.
- Modern firefighting equipment and easy evacuation plan for emergency exit as per labor law policy .
- Group insurance for all staffs and workers as per labor law 2006.
- Medical room with specialized doctor & nurse with emergency supporting equipment with medicines as per labor law 2006.



- Two separate sick rooms for Men & women .
- Clean and hygienic environment everywhere.
- Day-care center for babies of female workers as per labor law policy, including playing place with separate room for Brest feeding .
- Dining hall facility for all factory workers & staff as per labor law policy.
- Exhaust fans fixed to the wall for breathing environment and to make the floor cool.



- 24 hours standby generator facility. Capacity 620 KVA made in Germany
- 33000 KVA electric supply system for 24/7 electric facility.
- All over the factory well designed layout and fire evacuation plan for easy exit during emergency time.
- Separate Prayer rooms for male & female workers.
- Murad Apparels Ltd is fully equipped with public announcing system (PA system)
- For emergency exit each floor is having 4 numbers of staircases.



Factory Address & Bank Details

Factory

Murad Apparels Limited

South Gouripur, Asulia,

Savar, Dhaka-1341, Bangladesh .

Bank Details

EXIM Bank Limited.

Motijheel Branch

Dhaka, Bangladesh .

Web : www.eximbankbd.com

SWIFT : EXIBKBDDH001

Contact Person



❖ **M . A Hannan**

Chairman

Contact : +8801713012701

E-mail : info@muradapparelsLtd.com
chairman@muradapparelsLtd.com ;

❖ **Ali Ahammed Sumon**

Managing Director

Contact : +8801320-584678

E-mail : marketing.team@muradapparelsLtd.com

❖ **Md.Johirul Islam**

Manager Marketing & Merchandising

Contact : +8801957-775059

E-mail : merchandising-M@muradapparelsLtd.com

❖ **Md.Iftakhar Alam**

Director

Contact : +8801996804727

E-mail : director@muradapparelsLtd.com

❖ **Md.Amran Hossain**

Head of Admin, Hr & Compliance

Contact : +8801681518854

E-mail : compliance-1@muradapparelsLtd.com

❖ **Md.Rajib Hossain**

Executive-Hr & Compliance

Contact :+8801918-904751

E-mail : compliance-2@muradapparelsLtd.com

❖ **Md. Ekhtiar Ahmed**

Sr. Manager Marketing

Contact : +8801860674205

E-mail : marketing-2@muradapparelsltd.com

❖ **Md. Shajadul Hasan Shazal**

Manager Marketing &

Merchandising

Contact : +8801833101294

E-mail : shajadul@muradapparelsltd.com



Management



M. A. Hannan

Chairman

Cell : +8801713012701

Iftakher Alam

Executive Director

Cell :+ 8801996804727

Factory Details



- **Work Force:**
 - At this moment there are 1900 workers and staff working together.
- **Factory Space:**
 - 3 stored building. Ground floor is cutting and finishing, 1st and 2nd floor for sewing and also have a six storied building beside of main building only for bonded warehouse & finished goods store.
- Building Total Space : Total 1,45,504 Sft



Production Capacity:

- At this moment our production capacity is **500,000** pcs per month.
- Outwear can do 120K and Bottom 380K per month.
- Per month, consideration of 26 working days in a month.
- Total 16 lines & each lines of 65-70 machines lay out.



Our Products

We can manufacture all kind of
Washed and non washed woven Garments

- such as..

- ❏ All kinds of Jacket
- ❏ Casual Blazer
- ❏ Bib
- ❏ Coverall
- ❏ Cargo Pants
- ❏ Swim Shorts
- ❏ Fancy 5 pockets Jeans
- ❏ 5 pockets Pants
- ❏ Chino Pants
- ❏ Sports wear
- ❏ PU Leather Jacket and Bottom
- ❏ Night Wear Set

FABRICS

We can work on all kinds of fabric such as..

- ✦ Denim: All kinds of denim fabric
- ✦ Chambray
- ✦ Twill: All kinds of twill fabric
- ✦ Oxford Fabric
- ✦ 100% Polyester
- ✦ 100% Nylon
- ✦ CVC
- ✦ TC
- ✦ Fleece
- ✦ Poplin
- ✦ Bonded Fabric
- ✦ PU/Faux Leather & SUEDE Leather
- ✦ Coated Fabric
- ✦ Soft-shell
- ✦ Viscose
- ✦ Corduroy
- ✦ Linen
- ✦ American Crape
- ✦ Poly Moss etc.



Our Customers



- **ALDI** - **Germany**
- **LIDL** - **Germany**
- **Stooker Brands** - **Germany**
- **WIND** - **Germany**
- **Selling Group** - **Denmark**
- **JBS Textile Group** - **Denmark**
- **Startex** - **Denmark**
- **Terranova** - **Italy**
- **Calliope** - **Italy**
- **Academy** - **USA**
- **ORACON** - **Brazil**
- **Blue Notes** - **Canada**

Our Customers



STOOKER BRANDS

FASHION SYSTEMS



Terranova



BLU NOTES

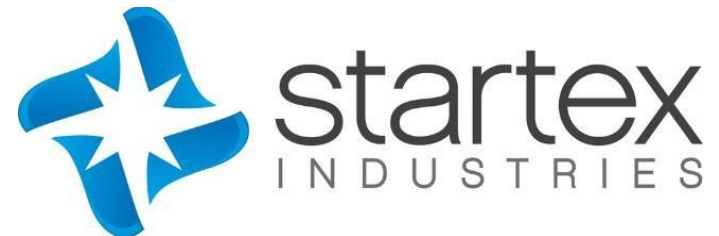

Sewing Floor Layout



MAL

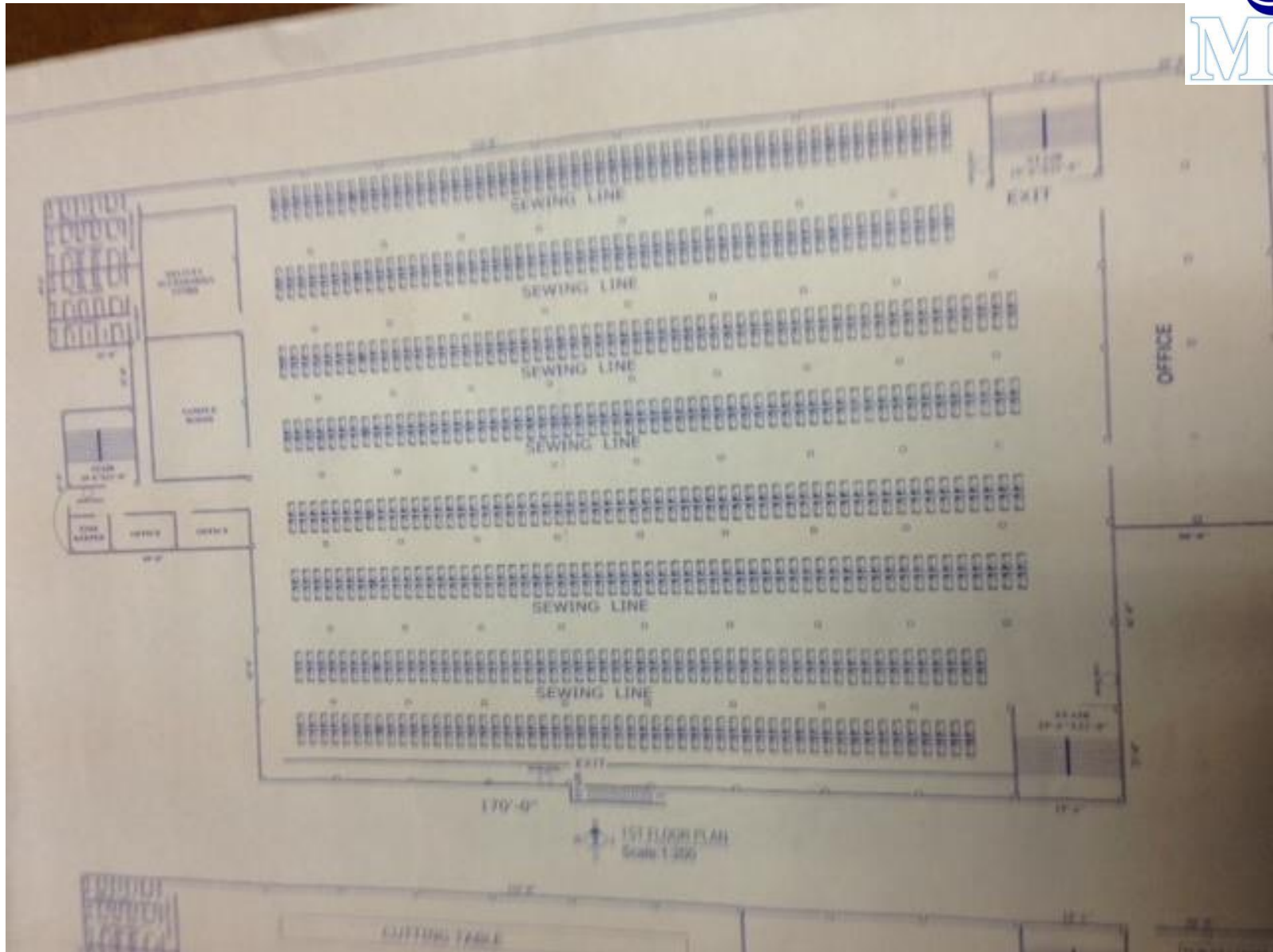

Cutting Floor Layout

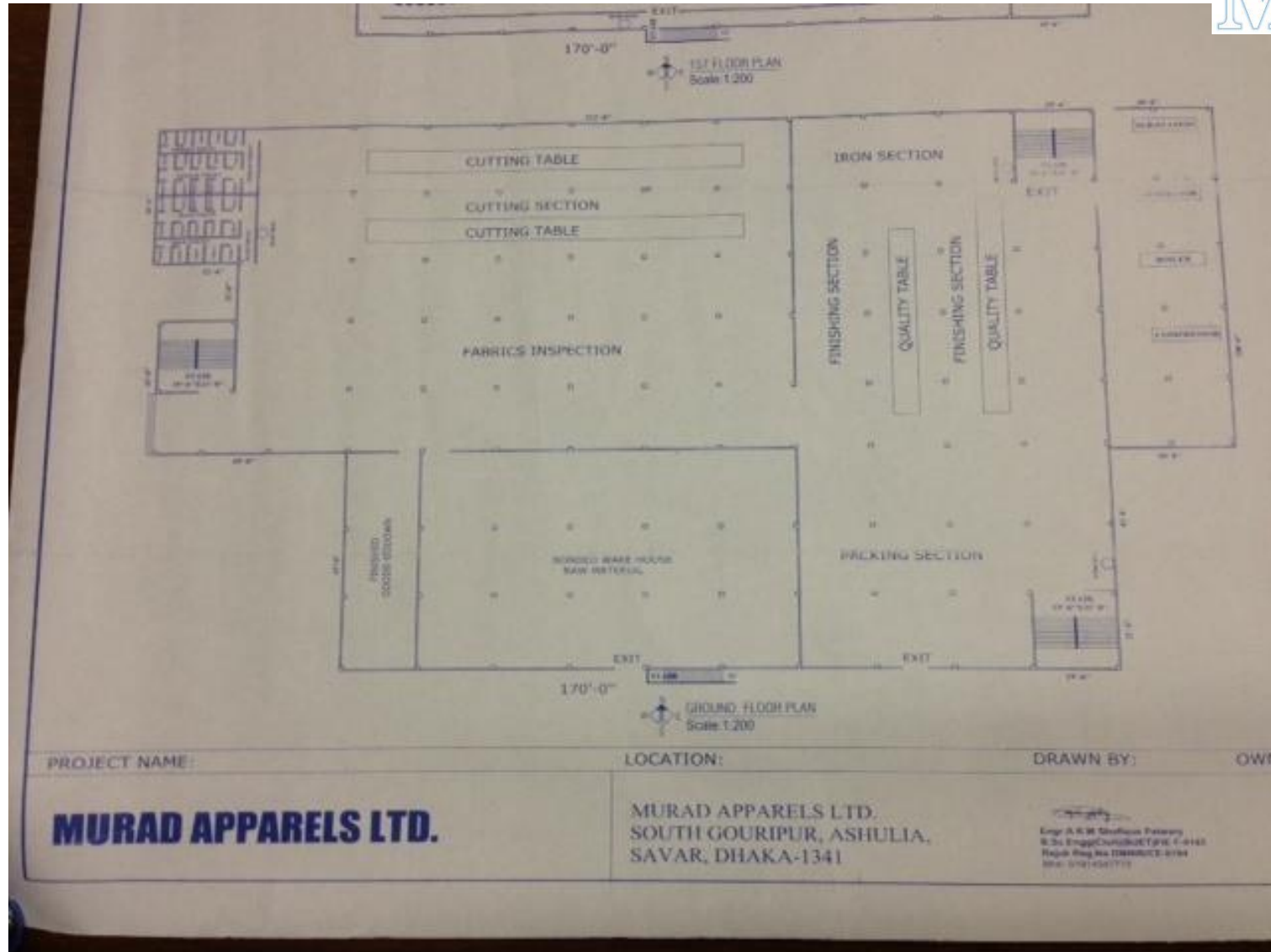

PROJECT NAME:

LOCATION:

DRAWN BY:

OWN

MURAD APPARELS LTD.

MURAD APPARELS LTD.
SOUTH GOURIPUR, ASHULIA,
SAVAR, DHAKA-1341

Engr. A. K. M. Shafiqul Kabir
B.Sc. (Engrg) Cumulative 1st Class
Reg. No. 123456789
Mob: 0171-1234567

Storing Facility:



- For any new order, all the raw materials (Shell fabric, pocketing fabric, fusing, trims and accessories, etc.) are received by the store department.
- Main functions of store department
- Fabric inspection 4 point system
- Accessories inspection AQL 2.5
- To maintain an inventory of all the material received.
- To issue material to the various departments as per their requirement.
- The material which are maintained by the stores department Fabric ,Trims, Machinery and equipments.



List of Machineries

Machine Name	Nos.
Plain Machine	396
Plain Machine Auto	368
Vertical Plain Machine	4
Kansai Machine	11
Kansai Special	8
Two Needle Machine	44
Two Needle Auto Machine	11
Over Lock Machine	176
Over Lock Auto Machine	50
Feed of the Arm	20
Button Hole Manual	8
Button Hole Auto	0



MAL

Bartack Machine	33
Blind Stitch Machine	9
Arm Hole Machine	3
Snap Button Machine	41
Snap Button Auto Machine	1
Eyelet Hole Machine	6
Zig Zag	25
Saddle Stitch Machine	2
Leather Base Stitch Machine	2
Bon Pocket Join Machine	1
Cutting Machine	10
Fusing Machine	2
Blower Machine	1



MAL

Steam Boiler	1
Flad lock	14
Flad Lock auto	1
Flad lock Flat bed	1
Cylinder Flad Lock	2
Chain Stitch	31
Steam Iron	32
Vacuum Table for Iron	24
Thread Sucking Machine	3
Fabric Inspection Machine	1
Fabric Inspection Table	1
Snap Pull Test Machine	2
Light Box	1

Sample Section

Sampling is the process by which a small number of garments are made so as to match the buyer requirement and to get approval from the buyer



Main functions of sampling department.

To develop samples as per the buyers requirements.

To develop a fabric consumption report for each order.

Various samples which are being developed at different stages are being mentioned below:-

- a) Proto Sample
- b) Fit Sample
- c) Sales Sample
- d) Pre Production Sample
- e) Size Set Sample



Cutting Section



MAL

Cutting is one of the important department of the manufacturing unit. The first stage in the manufacture of the garments is the cutting of the materials into the necessary patterns shapes.



The pattern shapes for these garments maybe drawn on a paper marker placed on top of the lay, or information as to their shape and position maybe held within a computer, to be plotted similarly on the paper marker or used to drive an automatic cutter.

Sewing Department

Sewing department is responsible for stitching the garment as per the sample and Tec pack provided by the sampling department.

Assembly line system is followed here with a combination of modular system. In this system there are different line/teams which individually do the production. The team works on few garments at a time instead of a bundle of garments and the operators are continuously motivated to work as a team and try to achieve the target production.



Quality Assurance

Piece Goods Quality Control

After 100% inventory, all the trims item with all accessories has to inspected as per AQL standard 1.5 . Failed items has to be keep on hold and it has to inform to merchandiser immediately and reject specimen has to be sent to merchandiser along with inspection report. Based on merchandising approval it has to be done 100% inspection before issuing trims & other accessories to production. Quantity less than 10,000 should be checked 100% .



Sewing Quality Control Policy



- If defect is found keep line supervisor informed and operator to carry Yellow tag
- If the defect was not corrected (repeated) in the next hour. Random check of cut panels at input section.
- 100% inspection at assigned initial key operation by line Q/C.
- operator will be marked with Red tag until the defect is corrected. Consult QC whether to stop the operation.
- QC is required to check all operators within first hour of work to ensure standards
- Random inspection at key operations to be carry out by QC for 10 garments (or pieces) and allow only one defect with own judgment or reject the whole bundle and hand over to line supervisor. All defective garments to be marked. Recheck the operation within next hour or at intervals of 10 min, 20 min, etc depending on the gravity of fault .

Finishing Department

Finishing department is responsible for incorporating the buyer's specified finishes to the stitched garments and packing those garments as per the specified packing details, specified by buyer. Each line takes input from the corresponding sewing line and prepares the garments for metal detector zone to check and prepare for packing .



Process flow for finishing of a Trouser

S.no	Operation	M/C used
1	Button Stitch	B/S m/c
2	Extra Loop Cut	
3	Thread Trimming Inside)	Trimmer
4	Iron Inside)	Iron
5	Quality Check (Inside)	
6	Thread Sucking	Sucker mc
7	Trim Threads outside)	Trimmer
8	Dust Removing	Air Jet
9	Inspection	
11	Buck Press W.B. , Front , Back	Buck Press

S.no	Operation	M/C used
12	Topper Finish	Topper
13	Final Iron	Iron
14	Measurement Check	
15	Final Inspection	
16	Staple W.B./joker Tag	Plastic Stapling
17	UPC Attach	Tag Gun
18	Size Sticker Attach	
19	Brushing	
20	Folding	
21	Poly Bag Packing	
22	Carton packing	



Doctor's Room

Medical room with specialized doctor & nurses with emergency supporting equipment with medicines as per labor law policy. Two separate sick rooms for Men & woman with four numbers of beds in each category for rest.



Day-care Centre



Day-care center for babies of female workers as per labour law policy, including playing place with separate room for Breast feeding.



Skill Building & Awareness Meeting



We always believe about motivation & training so Murad Apparels Ltd. Has taken special measure by providing full equipped training centre / conference hall for workers .



Needle Control



There are well maintain needle
Policy

All needles, or parts of broken/damaged
needles must be accounted for throughout
the
production process and complete
manufacturing unit.

Without exception, when a needle breaks
the operator must find *all the fragments*.



Dining & Pure Drinking Water



Dining hall facility for all factory workers & staff as per labour law policy.

Clean and hygienic environment everywhere.

Filtered drinking water is available for workers in production floor as well as dining hall.

Laws & Securities

- Modern firefighting equipment and easy evacuation plan for emergency exit as per labour law policy.



Products- Ladies Outwear



MAI



Products- Ladies Outwear



MAL



Products- Men's Outwear



Products- Ladies Bottom



Products- Ladies Bottom



Products- Men's Bottom



Products- Men's Bottom





Conclusion

Our conclusion is mainly to give end customer good quality finished products & keep delivery on time. Therefore, we have professional expert to manage our entire factory smoothly. We have recruited the most experience staff and Skilled workers to ensure our commitment of high quality garment's to our customers.



Moto of Murad Apparels Ltd. :

Our business policy is “Fashion and Quality garments at the best price within a committed time frame” We don’t compromise with any of them. The good prices are ensured due to good sources, efficient production planning and a good Quality Assurance system. We commit to supply top quality product at the best possible price.

Lead Time: Average Lead time of 90 to120 days.

Thanking You